

Wireless tubular motor EAM35



Translation of the original EC declaration of conformity



EC Declaration of Conformity

EC Declaration of Conformity in accordance with EU Directive 2006/42/EC Annex II 1.A.

The producer:

erfal GmbH & Co. KG

Gewerbering 8 • 08223 Falkenstein • Germany
Telefon: +49 (0) 3745 750 0 • E-Mail: info@erfal.de

declares hereby that the following products:

- Venetian blind Basic Line/Mega View with radio remote control and battery drive EAM24
- Pleated blind ESM1/FE with radio remote control and battery drive EAM24
- Pleated blind ESM5 with radio remote control and battery drive EAM24 Top Down
- Pleated blind EWM1/EWM2/PLE12-1/PLE12-2 with radio remote control and battery drive EAM24
- Pleated blind DFC 40 with radio remote control and battery drive EAM24
- Roller blind DFC 22 with radio remote control and battery drive EAM24
- M-roller blinds with radio remote control and battery drive EAM25
- XL-roller blinds with radio remote control and battery drive EAM35
- Double roller blinds with radio remote control and battery drive EAM25
- Roman blind Makom Plus with radio remote control and battery drive EAM25

comply with the regulations of the following EC Directives:

- Machinery (EC Directive 2006/42/EC)
- EMC-Directive 2014/30/EU
- Radio Equipment Directive 2017/53/EU

The objectives of the low-voltage directive 2014/35/EG were fulfilled.

The following standards and technical specifications have been applied:

EN 13120 2014-09	Interior closings – requirements of safety and performance
EN IEC 55014-1:2021/-2:2021	Electromagnetic compatibility - Requirements for household appliances, electric tools and similar apparatus
EN 60335-1:2020-08	Security of electrical devices for the domestic use and similar purposes – Part 1: General requirements
EN 60335-2-97-100:2021-03	Security of electrical devices for the domestic use and similar purposes – Part 2-97: Special requirements for shutters, sun blinds, venetian blinds and similar furnishings
EN 62233:2008-11	Measurement methods for electromagnetic fields of household appliances and similar apparatus with regard to human exposure

Responsible for documentation is:

erfal GmbH & Co. KG
Alexander Feiler
Gewerbering 8
08223 Falkenstein / Germany

Falkenstein, 06.05.2024

Jörg Erler, Managing Director

Product description



Name:	Akkumotor EAM35
Torque:	6 Nm
Speed:	24 rpm
Voltage:	5 V
Connection:	USB-C
Performance:	3.23 A
Radio frequency:	433,925 MHz
Capacity:	3200 mA
Temperature range:	0°C / 50° Celsius
Protection class:	IP20
Conformity:	CE

Note

- eACCU-wireless-drives must be protected against shocks during transport, storage and installation. Damaged components must be replaced.
- Please charge the battery full before the first use or when the signal tone indicates low battery! Charging time approx. 6 hours. The LED on the charger lights up green during charging and green when fully charged.
- The programming of the channels as well as the end positions are permanently stored and remain even when the eACCU is completely discharged.
- The radio range is up to approx. 20 m in closed rooms.
- A minimum distance of 20 cm must be respected to avoid interferences when using eACCU-wireless drives.

Overview

Motor

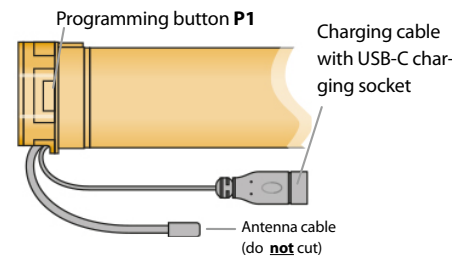

Controls

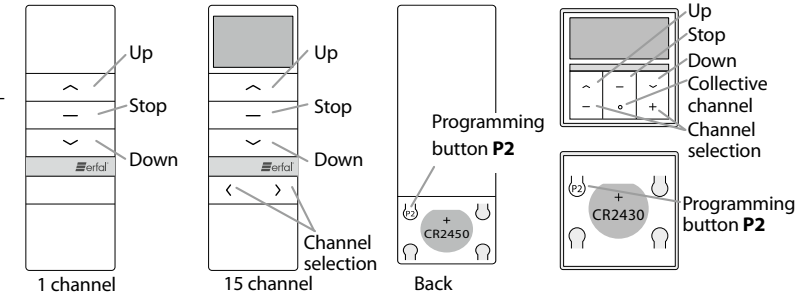

Programming instructions

You will receive a preconfigured sun protection product with preconfigured end positions.

A Fine adjustment of the end positions

ATTENTION! Motor moves to continuous operation after longer keystroke! Urgently stop before reaching the end position and then proceed through a tip.

Fine adjustment of upper end position

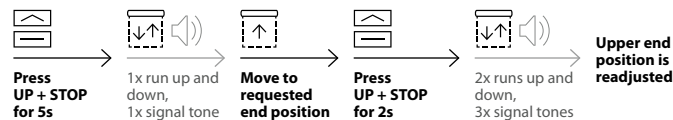

Fine adjustment of lower end position

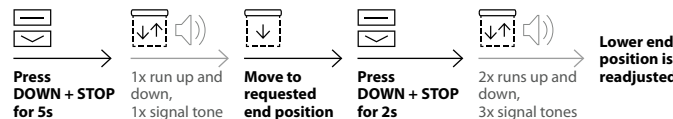

Programming videos



Watch online:

<http://bit.ly/eACCU-Bedienungsanleitungen>

MAKE YOUR CONTRIBUTION TO ENVIRONMENTALLY FRIENDLY RECYCLING.

After use, separate the system, motor and (rechargeable) batteries and dispose the parts separately. Due to the obligations resulting from the WEEE directive of the EU, erfal, as a manufacturer or distributor of electrical and electronic devices, takes back freely controls, drives, other electrical accessories, old batteries and accumulators. Contact your seller for the exact procedure. End users are legally obliged to delete personal data on old devices before disposal. Further, it should always take place in the discharged state and secured against short circuits.

Subject to technical change. 06 / 2022



04046046536123

B Basic settings

Only necessary for motor replacement or after factory reset.

For adjusting the end positions see **A** „Fine adjustment of the end positions“!

If there is an already programmed remote control, continue with **G** „Remote control and channels“.

Configuring remote control

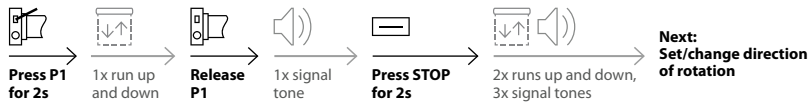

Set/change direction of rotation

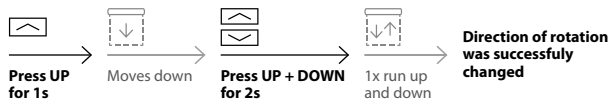

C Set end positions

ATTENTION! Motor moves to continuous operation after longer keystroke! Urgently stop before reaching the end position and then proceed through a tip..

For adjusting the end positions see **A** „Fine adjustment of the end positions“!

Set upper end position

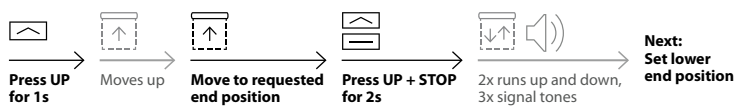

Set lower end position

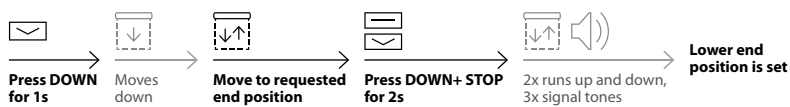

D Change operation mode to jog mode

Operating in jog mode: The motor moves to continuous operation after 2 sec. of key pressing. Repeat the programming step to switch back to continuous operation.



E Change speed

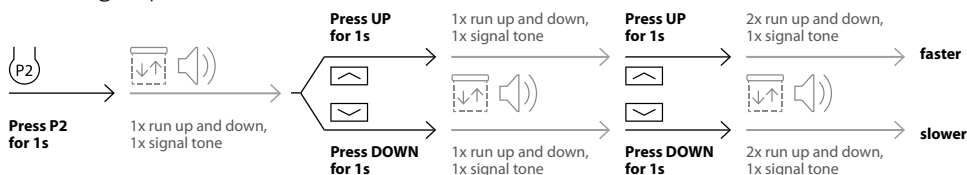

F Set intermediate positions/ stops

Setting custom stop position End positions must be set!

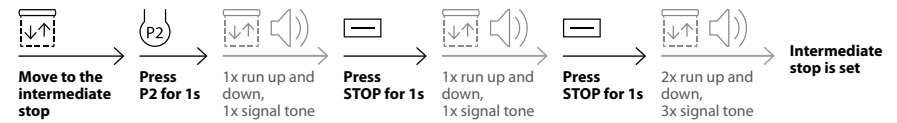

Approach custom stop position

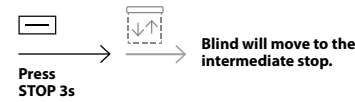

Remove custom stop position

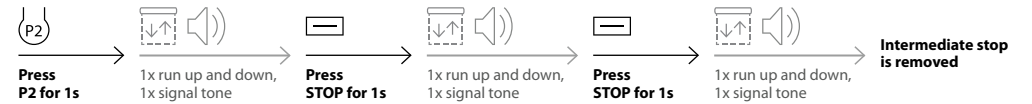

G Remote control and channels

Add remote control or channel

A motor can store up to 10 remote control channels, learning further channels is rejected by the motor.

Note: **A** is the already programmed remote control, **B** is the new remote control which has to be programmed!



Delete remote control or channel

Note: **A** and **B** are the already programmed remote controls, **B** is the remote control which has to be programmed!



H Factory reset

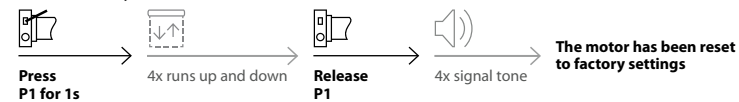

I Malfunctions and troubleshooting

Error	Cause	Solution
Motor is not moving	a) The battery is empty.	a) Charge the battery.
	b) The battery is charging, but not moving.	b) Battery was deeply discharged, wait for certain state of charge.
	c) The remote control is not trained.	c) Follow programming step B.
	d) P1 programming button is pressed but no reaction.	d) The motor is defect, contact sun protection specialist.